

Remote Control

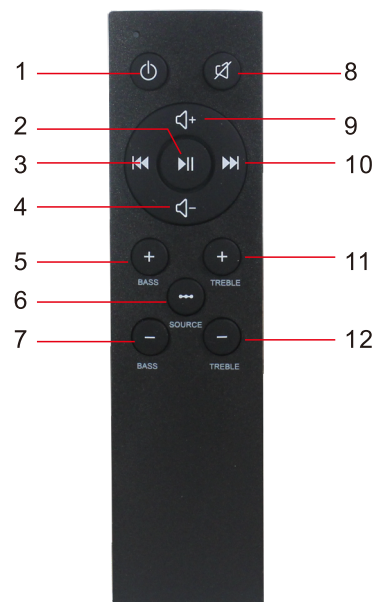

1. Power on/off
2. Play/pause
3. Previous song
4. Volume decrease
5. Bass increase
6. Source selection

7. Bass decrease
8. Mute
9. Volume increase
10. Next song
11. Treble increase
12. Treble decrease

User's Manual

Qtex

4-CHANNEL WIFI AUDIO AMPLIFIER

QAA WF4120



Description

QAA WF-4120 is a compact 4 x 120W amplifier with WiFi, Bluetooth, USB and AUX inputs. It is designed to turn the traditional passive speakers into multi-functional wireless speakers. It includes a subwoofer phase switch, with four outputs in stereo mode for stereo sound. In bridged mode, CH1 and CH2 are in subwoofer mode, while CH3 and CH4 are in full-range mode, forming a 2.1 audio system.

Features

- ▶ Allow wireless music streaming via WiFi or Bluetooth
- ▶ With 4 x 120W stereo speaker outputs
- ▶ With USB reader and AUX input for more audio sources
- ▶ Can adjust volume of each channel independently
- ▶ Supports online music, Internet radio, Airplay, DLNA
- ▶ Convenient music management by WiiM APP

Specification

MODEL	QAA WF4120
Stereo Mode	
Rated Output Power	4*120W (4ohm)
Input Sensitivity	1V(1KHz)
THD+N	< 0.1%
SNR	> 90dB
Frequency Responses	20Hz-20KHz -2dB
Bridge Mode	
Rated Output Power	250W(4ohm)
Input Sensitivity	300MV(60Hz)
THD+N	< 0.1%
SNR	> 90dB
Frequency Responses	20Hz-200Hz
Mic	
Input Sensitivity	300MV
THD+N	< 0.1%
SNR	> 72dB
Frequency Responses	150Hz-20KHz±2dB
Product Dimensions	430x265x44mm
Net Weight	3.4kg

FREQUENTLY ASKED QUESTIONS

Can I stream music from my Mac or PC?

Yes, you can stream from Mac or PC using iTunes Airplay.

On PCs you can also stream from Windows Media Player to your amplifier via a UPnP or DLNA certified controller, such as Play To. Just make sure your device and amplifier are all on the same wifi network.

Please follow these steps:

- 1.Open Windows Media Player
- 2.In the play list, Click Play To and select the Amplifier device Or
- 1.Right click on the song and Click Play To
- 2.Music starts streaming. If the speaker / device is not visible on the Media Player, go to Stream > More streaming options, and make sure the amplifier is in Allowed state.

Can I login multiple Speakers to Spotify at the same time?

You should be able to login multiple devices to your Spotify premium account but you can only stream Spotify from one device (or multi-room group) at a time. The Spotify App allows you to switch among different Spotify Connect clients. If you group multiple amplifiers you'll only see the group master amplifier on the Spotify App.

What's the maximum number of amplifiers that can stream music on the same wireless network?

For this current version of the you can have at most 6 amplifiers in order to ensure a stable Wi-Fi connection. In future versions we are planning to allow more devices on the same Wi-Fi network, so appreciate your patience as we work on that!

Do the Speakers need to be on the same firmware version to stay in sync with one another?

Yes! Please keep the firmware in sync since we are still optimizing certain features that require the latest firmware.

TROUBLESHOOT

SETTING UP THE AMPLIFIER

How do I connect the WiFi Amplifier to my Wi-Fi network?

You'll need to download the WiiM app for iOS or Android. Once you download it, the app will help you through the setup process.

I'm still having trouble setting up the Wi-Fi connection for my amplifier. How can I fix the problem?

Try the following steps as an alternate way to set up your Wi-Fi connection:

1. Connect your phone or PC with your WiFi amplifier directly by finding the SSID (Format: QAA WF4120) in your Wi-Fi setting.
2. Launch an internet browser in your device and enter <http://10.10.10.254>
3. Click the Wi-Fi button in the top left corner of the page, and select the router that you want to connect to. Enter the password to connect.

How do I initiate a factory reset? Here are two ways you can reset the WiFi amplifier:

Method 1: Locate the WPS button on the unit and press it for 6-8 seconds and then it will restart to its original factory state.

Method 2: 1. Find the unit you want to reset in the app 2. Go to the Setting button and find amplifier Info and click Restore Factory Settings

Will I be able to listen to Apple Music through the amplifier from my iPhone, iPad, or Macbook Pro?

Yes.

How do I stream music from my DLNA enabled NAS (Network-Attached Storage) device?

First make sure your DLNA enabled NAS device is powered on and connected to the same wireless network as your amplifier and smartphone/tablet. Tap the WiiM icon in the top left of the WiiM app. Select My Music, and select your device. You can then select music to stream from the DLNA enabled NAS device to your amplifier. If you have any issues streaming music from your device, please check that your firmware is up to date.

Can I use my phone while playing music?

Yes, you can. Once your amplifier is connected to your music, you can answer calls, make phone calls, turn off your phone and your Speaker will continue to stream music.

Front Panel

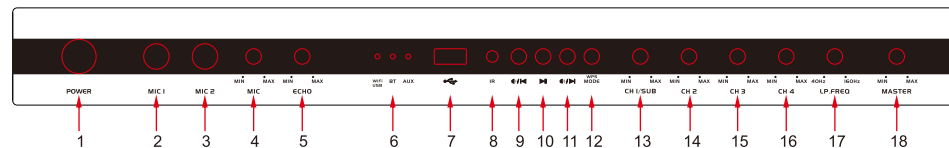

1. Power switch
2. MIC1 input socket (6.3mm)
3. MIC2 input socket (6.3mm)
4. MIC volume control potentiometer
5. ECHO volume control potentiometer
6. Input mode indicator
7. USB input socket (supports up to 64GB capacity)
8. Infrared receiver
9. Short press for previous song, long press to decrease volume
10. Play/Pause
11. Short press for next song, long press to increase volume
12. Short press for input mode selection, long press for network reset
13. In STEREO mode, controls volume for CH1; in BRIDGE mode, controls volume for SUB
14. In STEREO mode, controls volume for CH2
15. In STEREO mode, controls volume for CH3
16. In STEREO mode, controls volume for CH4
17. In BRIDGE mode, adjusts subwoofer output frequency
18. Overall music volume control

Rear Panel

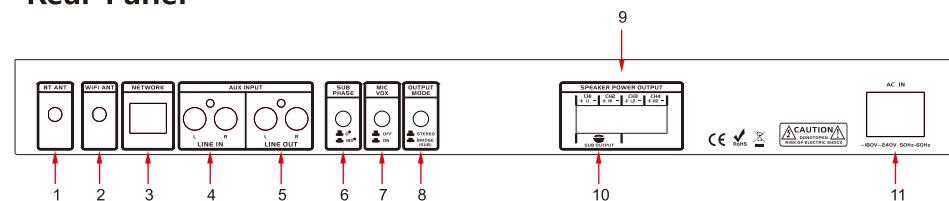

1. Bluetooth external antenna
2. WiFi external antenna
3. RJ45 LAN network connection socket
4. Line input
5. Line output
6. SUB phase conversion switch
7. MIC VOX conversion switch: In the raised position, both Microphone and music signals play simultaneously. When pressed, if Microphone signal is detected, it automatically mutes the music signal. After 5 seconds of no MIC signal, it automatically restores the music signal.
8. Output mode switch: In the raised position, operates in STEREO mode where the four outputs are in a 2*2 stereo mode (L1, R1, L2, R2). When pressed, switches to BRIDGE mode where CH1 and CH2 are bridged and combined. In this mode, CH1 and CH2 operate in SUB mode, while CH3 and CH4 operate in full frequency mode, completing a 2.1 combination. Note: This mode switch should be operated with the product powered off!
9. 2*2 stereo output mode speaker terminal and its speaker wiring indication.
10. In BRIDGE mode, SUB speaker wiring indication. Note: In this mode, both CH1 and CH2 operate in SUB mode. If connecting two Subwoofers, their impedance should be greater than 8 ohms.
11. AC power input socket

WIFI & APP OPERATIONS



Our Wi-Fi speaker uses the Wiim App for music management. You may download this APP from App Store or Google Play.

The Wi-Fi speaker's Service Set Identifier(SSID) is: ex. "QAA WF4120 "

TURNING ON THE ACTIVE MASTER SPEAKER

To turn this unit ON, plug in the power cord. When the unit turns on, you will here the voice prompt. In order to connect this device to your Wi-Fi, you need to know your network credentials.

MINIMUM REQUIREMENTS

The APP is compatible with iPhone, iPod Touch and iPad devices running on iOS 6.0 or later and Android 2.3.3 or later.

NETWORK REQUIREMENTS

To access music services, Internet radio, and any digital music stored on your smart device or DLNA enabled Network-Attached Storage (NAS) device, your network must meet the following requirements:

NOTE: If you want to stream music through built-in App features such as Spotify, you will need to have a high speed internet connection. (Playback experience may differ depending on your internet connection speed.)

- If you are going to use the Wiim App on Android or iOS devices, a Wi-Fi Network will be required.
- You need to have your Wi-Fi network SSID and password.
- Your network configuration should not be in isolation mode
- Our system only supports 2.4GHz Wi-Fi.

CONNECT YOUR WI-FI AMPLIFIER TO YOUR NETWORK VIA Wiim PLYAER APP.

- Install the Wiim App to your Smartphone or Tablet.
- Ensure that your Smartphone is connected to the same network that you are going to connect your Wi-Fi Audio System to.
- Open the Wiim App and you will see the Figure 1.
- Select 'Add Device' at the bottom of the screen then you will see the Figure 2.
- Select 'Wiim Cobblestone' then you will see the Figure 3.

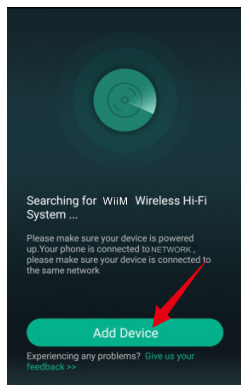

Figure 1

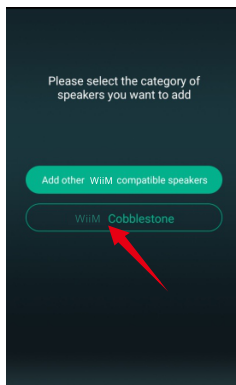

Figure 2

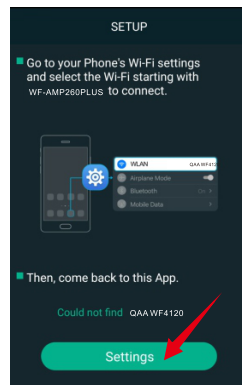

Figure 3

LANGUAGE SETUP (Figure 21)

You can click the "System" tab to select the language you want, then save it.

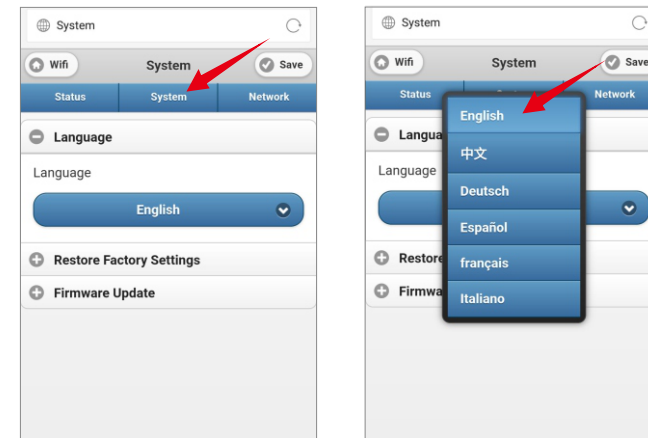

Figure 21

CHANGE DEVICE NAME (Figure 22)

The factory default device name is ex. "QAA WF4120 ", you can click the "Network" tab to be the one you want, and click "OK" then to "Save" it.

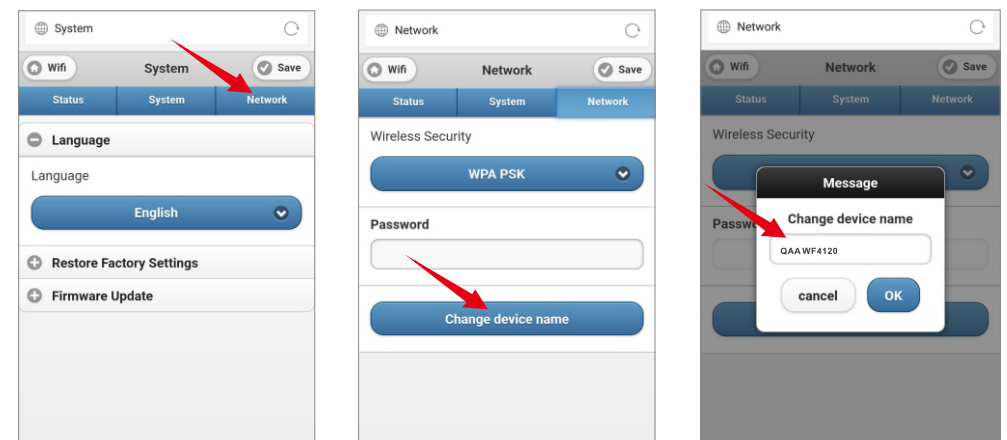

Figure 22

ALARM CLOCK (Figure18)

The alarm lets you wake up to your own music from the iTunes library or your subscribed music services. You can set several alarms and specify for each alarm which days they should wake you up and which playlist to use.

SLEEP TIMER (Figure19)

You can set a timer on your device and set a sleep timer for it to turn off.

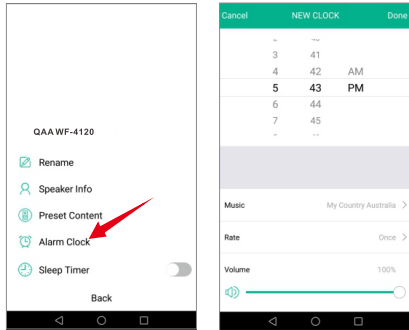

Figure 18

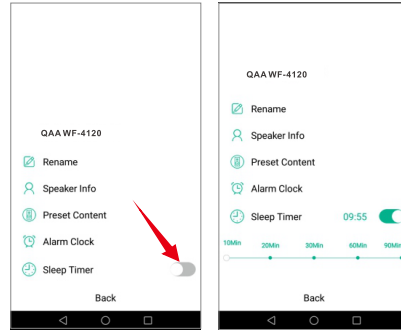
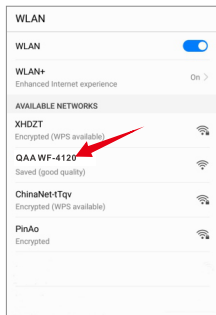

Figure 19

WEB BASED WI-FI SETUP

CONNECT SPEAKER TO WI-FI NETWORK (Figure20)

- Open the **Wi-Fi Discovery Menu** on your Smartphone or Tablet and look for the Speaker Service Set Identifier (SSID), ex. "QAA WF-4120".
- Select to connect your device to the Speaker hotspot network
- Open a web browser on your Smartphone or Tablet and input '10.10.10.254' into the URL bar. This will lead you to the Speaker Wi-Fi setup page.
- Select your network from the list of available networks and input your home Wi-Fi password.
- Your device will disconnect from the Speaker network and the Speaker will then connect to your Wi-Fi network.
- Your device will say "Connected" to indicate that your Speaker has successfully connected to your Wi-Fi network.



Wi-Fi Discovery Menu

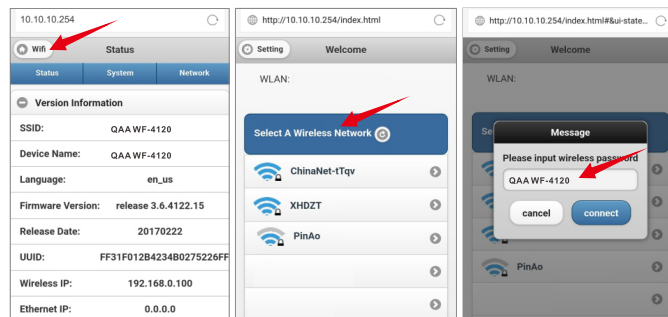

Connecting the speaker to Wi-Fi network
Figure 20

- Enter the WLAN setting on your phone, then you will see Figure 4.
- Select the Wi-Fi amplifier's SSID, ex. "QAA WF-4120", then you will see the Figure 5.
- Select 'CONNECT' then you will see the Figure 6.
- Select 'NO' you will see Figure 7, then exit the WLAN Setting.

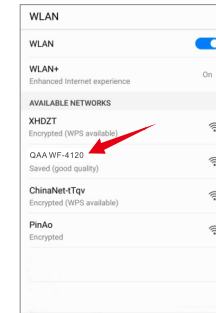

Figure 4

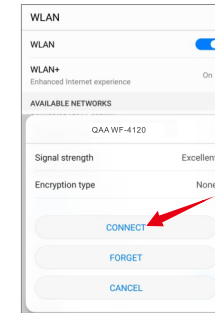

Figure 5

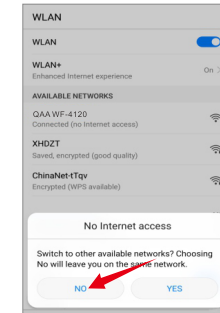

Figure 6

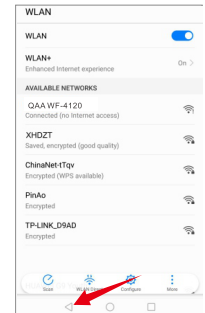

Figure 7

- Enter the Wiim Player APP, you will see the Figure 8.
- Select your Wi-Fi SSID and input its password, then 'Continue', when connected successfully you will see the Figure 9.
- Select 'Next', a pop up menu Figure 10 will come up and you can select the name from pre-defined names or write a desired name for your unit. This will help you to easily differentiate units from one other on different locations (You cannot have two units with same name in the Wiim Player App).
- As the Figure 10 shows, press the icon '>' to enter the DEVICE LIST as the Figure 11

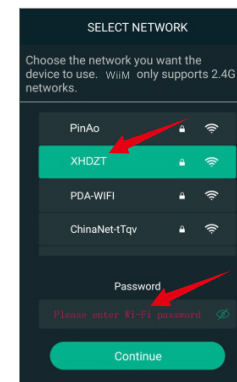

Figure 8

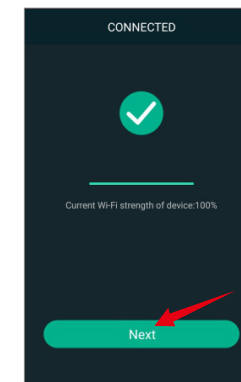

Figure 9

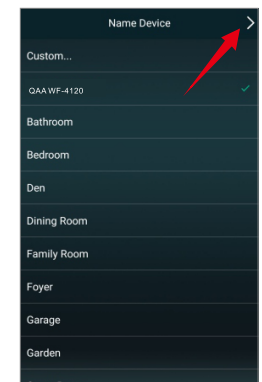

Figure 10

•Swipe screen right to enter the player screen as Figure 12. And you can now play and enjoy your music.

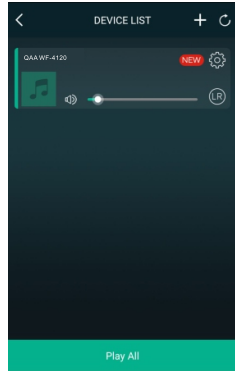

Figure 11

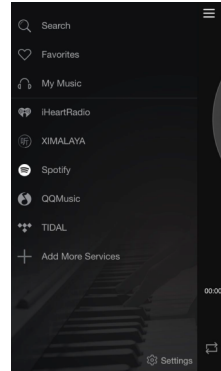

Figure 12

INSTRUCTIONS OF PLAYING MUSIC

MyMusic

Through 'My Music', you can access the music that you have saved on your iOS or Android device's internal storage. You can also access music stored in music server. There are other options such as "recently played" and user created playlists etc. In iOS, only music sync from your iTunes are accessible by the Wiim. It is grouped by artists, album, playlists, or track. In each category, it is in alphabetical order. On Android device, all the music in the device is accessible, and it can be grouped by folder too.

Spotify

You can control music play through your Spotify app. Go to the Connect screen and select your Speaker. For example, 'FamilyRoom'. Once you connect, you can stream Spotify to any room connected with a Wi-Fi speaker. In order to use Spotify on your Wi-Fi speakers, you need to install Spotify on your connected Smartphone or Tablet. Go to the App Store or the Play Store and search for the Spotify App. Install the App and login into your account. If you do not have an account, you will need to set one up.

iHeartRadio

iHeartRadio allows you to stream radio stations to your Wi-Fi speaker. Enter the menu and select 'iHeartRadio'. Select 'Genre' to choose the genre of radio you would like to listen to or select 'Country' and then the 'Region' to select localized radio stations.

AirPlay

You can play music through AirPlay on your iOS device. To do this, you need to ensure that your iOS device and the Wi-Fi amplifier are connected to the same Wi-Fi network. Swipe up from the bottom of your iOS device and select 'AirPlay'. Select your Wi-Fi speaker and start playing your music. NOTE: On multi-channel mode when you have two or more Wi-Fi devices together, selecting AirPlay will play the selected music on all the speakers. Ensure that you increase the volume on the unit when listening to music on AirPlay.

TIDAL

TIDAL is the perfect match for the Wi-Fi devices, streaming music in lossless, high fidelity audio quality, ensuring the best sound experience possible. Add high definition music videos, curated editorials by music journalists, artists and experts, and so much more. NOTE: Currently only available on iOS.

QQMusic

With millions of tracks on QQMusic, the right music is always at your fingertips whether you're working out, playing or relaxing. Diversified ways are here to discover music you will love. The latest hits, the artists or DJs you like, intelligent recommendation based on your listening history, your next favorite songs are waiting for you. NOTE: Currently only available on iOS.

CHECK WI-FI STRENGTH

To achieve smooth streaming experience, your Wi-Fi device should have good network connection with your connected router. When connected with Wi-Fi, please check the Wi-Fi strength when you have problem with streaming experience. The steps to check the Wi-Fi strength are as follows:

1. Enter the **DEVICE LIST** menu.
2. Select the gear icon on the Wi-Fi device you want to check, then you will see the **Figure 13**.
3. Select "Speaker Info" to see if your Wi-Fi connection is good enough as the **Figure 14**.

SPEAKER WIFI PASSWORD PROTECTION

If you don't want the speaker to be public, you can encrypt it by enabling "Add Password Protection"

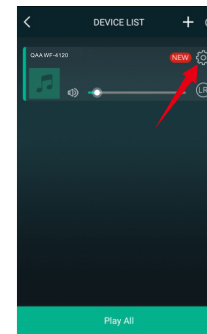

Device List

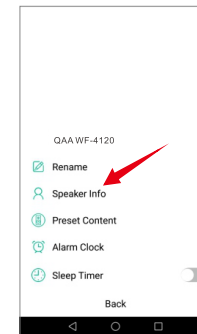

Figure 13

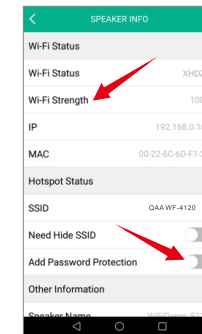

Figure 14

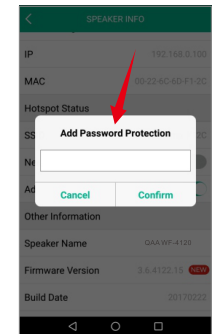

Figure 15

FACTORY RESET (Figure 16)

If you want to restore factory settings, select the "Restore Factory Settings" at the bottom of SPEAKER INFO menu to confirm.

FIRMWARE UPDATE (Figure 17)

If you see a "New" icon next to the setting button, it means a new firmware is available for your unit. In order to apply this firmware, tap on "New" and you will see a pop up message. Select upgrade and wait until the device upgrade process finishes.

NOTE: Do not conduct any other operation via the phone or the speaker unit while the firmware update is in progress.

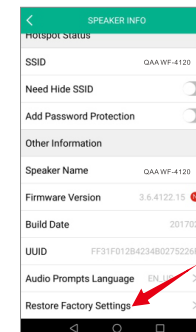

Figure 16

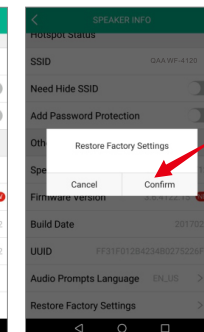

Figure 17

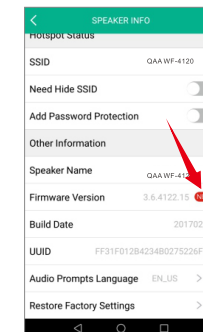

Figure 18

